

# TALL DOUBLE OVEN STAP1D

EUROPEAN  
**Frameless**  
Cabinet Box Construction

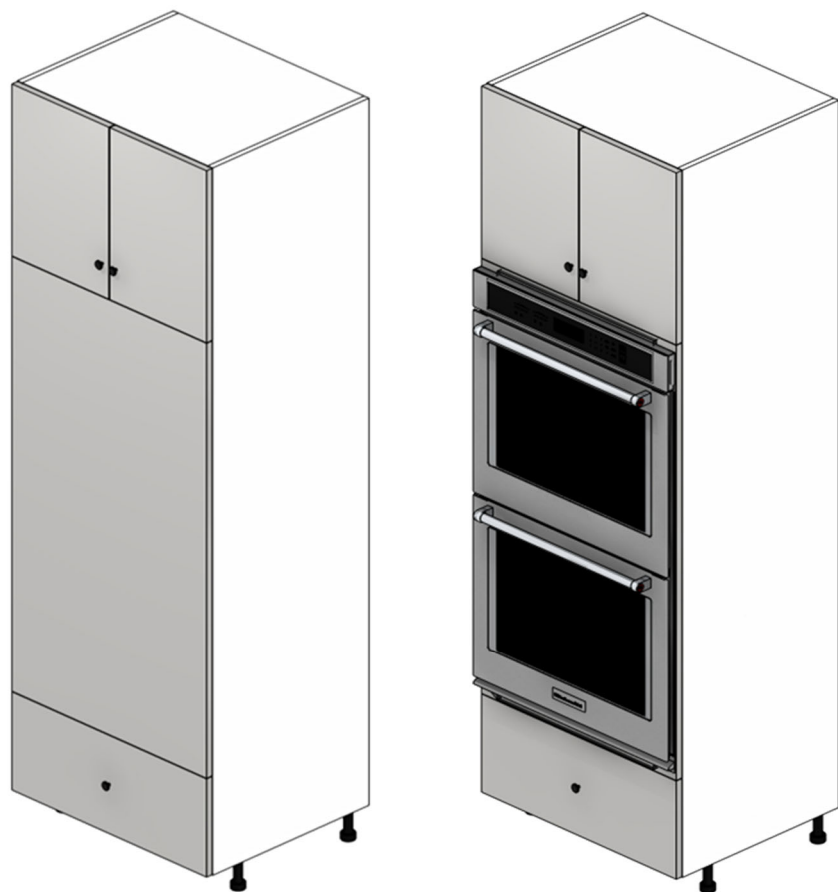

## Working With A Built-In Appliance Cabinet

All Cabinets.com European Frameless appliance cabinets are manufactured with a front panel that is intended to be modified on-site to fit specific appliances. This allows flexibility to fit a variety of appliance makes/models and gives the ability to get a custom fit. It is important to understand what appliance types work best and where additional on-site accommodations may be needed for specific appliances. Be sure to consult the appliance manufacturer's installation instructions for specifications on minimum and maximum cutout size requirements.

## Tall Double Oven Cabinet (STAP1D)

This cabinet has a 53" high center panel and is intended for a wall-mount built-in appliance combination. Refer to the cutout chart to determine the maximum cutout sizes allowable. It is recommended that a Double Oven Cabinet without a drawer be used for full-sized wall-mount ovens, as the center panel is taller and will more readily accommodate them; consult with your Cabinets.com Designer for more information.

# TALL DOUBLE OVEN STAP1D

EUROPEAN  
**Frameless**  
Cabinet Box Construction

 **Cabinets.com**®

## Maximum Cut-Out Dimensions

One loose shelf and additional material for appliance support is supplied with this cabinet.

|                   | Oven Panel<br>Max Cut-Out |     | Doors<br>Height |
|-------------------|---------------------------|-----|-----------------|
| 84" Tall Cabinet  | A                         | B   | C               |
| TA2784-PNL-STAP1D | 23"                       | 51" | 14-3/4"         |
| TA3084-PNL-STAP1D | 26"                       | 51" | 14-3/4"         |
| TA3384-PNL-STAP1D | 29"                       | 51" | 14-3/4"         |
| TA3684-PNL-STAP1D | 32"                       | 51" | 14-3/4"         |
| 90" Tall Cabinet  | A                         | B   | C               |
| TA2790-PNL-STAP1D | 23"                       | 51" | 20-3/4"         |
| TA3090-PNL-STAP1D | 26"                       | 51" | 20-3/4"         |
| TA3390-PNL-STAP1D | 29"                       | 51" | 20-3/4"         |
| TA3690-PNL-STAP1D | 32"                       | 51" | 20-3/4"         |
| 96" Tall Cabinet  | A                         | B   | C               |
| TA2796-PNL-STAP1D | 23"                       | 51" | 26-3/4"         |
| TA3096-PNL-STAP1D | 26"                       | 51" | 26-3/4"         |
| TA3396-PNL-STAP1D | 29"                       | 51" | 26-3/4"         |
| TA3696-PNL-STAP1D | 32"                       | 51" | 26-3/4"         |

